

EFD 型磁芯

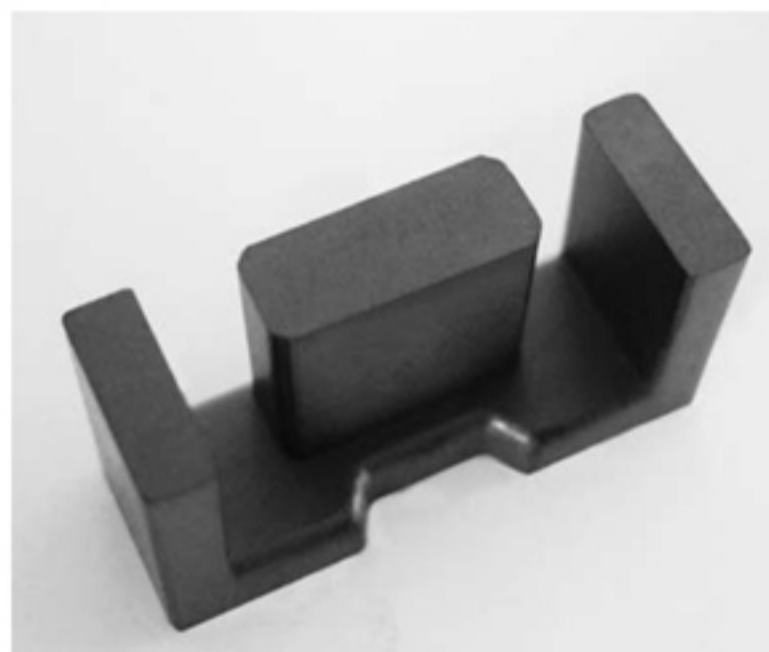
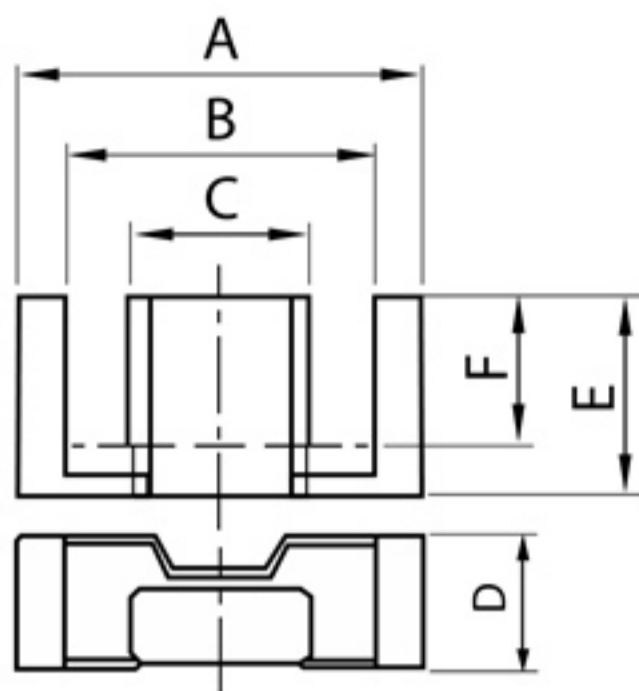

适用功率材料R2KB1

型号	尺寸					
	A (mm)	B (mm)	C (mm)	D (mm)	E (mm)	F (mm)
EFD10	10.5 \pm 0.3	7.65 \pm 0.25	4.55 \pm 0.15	2.7 \pm 0.1	5.2 \pm 0.1	3.75 \pm 0.15
EFD12	12.6 \pm 0.3	8.0 \pm 0.20	6.20 \pm 0.3	3.4 \pm 0.1	5.75 \pm 0.1	3.40 \pm 0.15
EFD15	15.0 \pm 0.4	11.0 \pm 0.35	5.3 \pm 0.15	4.65 \pm 0.15	7.5 \pm 0.15	5.50 \pm 0.20
EFD20	20.0 \pm 0.55	15.4 \pm 0.5	8.9 \pm 0.20	6.65 \pm 0.15	10 \pm 0.15	7.70 \pm 0.25
EFD25	25.0 \pm 0.65	18.7 \pm 0.60	11.4 \pm 0.20	9.1 \pm 0.20	12.5 \pm 0.15	9.30 \pm 0.25
EFD30	30.0 \pm 0.8	22.4 \pm 0.75	14.6 \pm 0.25	9.1 \pm 0.20	15.0 \pm 0.15	11.2 \pm 0.30

型号	C1 (mm ⁻¹)	Ae (mm ²)	Le (mm)	Ve (mm ³)	W (g)	A _L (nH/N ²) (\pm 25%)
EFD10	3.3	7.2	23.7	171	0.9	500
EFD12	2.5	11.4	28.5	325	1.7	700
EFD15	2.27	15.0	34.0	510	2.8	700
EFD20	1.52	31.0	47.0	1460	7.0	1150
EFD25	1.00	58.0	57.0	3300	16.0	2000
EFD30	0.98	69.0	68.0	4700	24.0	1900